

## Fire Rating 3 Hours (SS-22)



### Description

Frame : JayaBMS Wall Track, JayaBMS Deflection Head Track, JayaBMS C Stud

Lining : 3 layers of USG Boral Firestop 16mm (both sides)

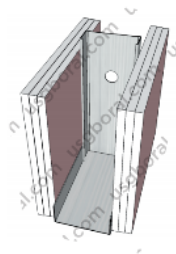
Weight :  $\pm 80 \text{ kg/m}^2$



STUD SIZE (mm)		MAXIMUM HEIGHT (mm) Non-Load Bearing Studs			WALL THICKNESS (mm)	 FIRE RATING (minutes)	 ACOUSTIC RATING (STC)	
Width	Thickness	@600mm centres	@400mm centres	Grade BS 5234			Without Insulation	Insulation Mineral Wool 50mm
64	0.5	5200	5400	Severe Duty	160	180	55	63
	0.7	5350	5600			180		
76	0.5	5900	6100		172	180	56	63
	0.7	6050	6250			180		
92	0.5	6500	6700		188	180	57	63
	0.7	6650	6900			180		
100	0.5	6800	7000		196	180	57	63
	0.7	6950	7250			180		
150	0.7	8500	9150	246	180	59	63	